

HYDROSTATIC STEERING UNITS

HKU.../4

Open centre, non load reaction

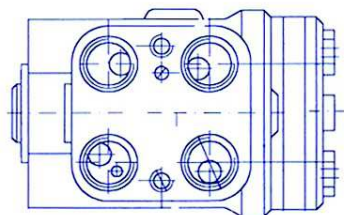

ORDER CODE	cm3/rev	RF	SV	P MAX BAR	LIST PRICE
HKU 40/4	39,6			160	255.34
HKU 50/4	49,5			160	255.34
HKU 63/4	65,6			160	255.50
HKU 80/4	79,2			160	257.05
HKU 100/4	99			160	259.70
HKU 125/4	123,8			160	264.24
HKU 160/4	158,4			160	273.11
HKU 200/4	198	-	-	160	287.34
HKU 250/4	247,5			160	306.09
HKU 320/4	316,8			160	324.24
HKU 400/4	396			160	338.56
HKU 500/4	495			160	530.09
HKU 630/4	618,7			140	626.02
HKU 800/4	793			140	703.24
HKU 1000/4	990			100	831.39

HKUS.../4

Open centre, non load reaction, with valves

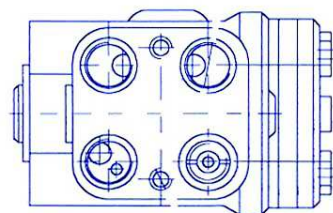

ORDER CODE	cm3/rev	RF	SV	P MAX BAR	LIST PRICE
HKUS 40/4/100	39,6			160	299.01
HKUS 50/4/100	49,5			160	299.01
HKUS 63/4/100	65,6			160	299.90
HKUS 80/4/100	79,2			160	303.51
HKUS 100/4/100	99			160	305.14
HKUS 125/4/100	123,8	100 bar	160 bar	160	310.48
HKUS 160/4/100	158,4			160	316.04
HKUS 200/4/100	198			160	333.55
HKUS 250/4/100	247,5			160	349.27
HKUS 320/4/100	316,8			160	359.95
HKUS 400/4/100	396			160	374.23
HKUS 500/4/100	495			160	565.72

RF = RELIEF VALVE SV = SHOCK VALVES

HKUS.../5 LOAD SENSING

Open centre, non load reaction, with valves

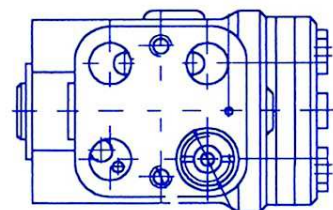

ORDER CODE	cm3/rev	RF	SV	P MAX BAR	LIST PRICE
HKUS 40/5/100	39,6			125	317.20
HKUS 50/5/100	49,5			150	317.20
HKUS 63/5/100	65,6			175	320.33
HKUS 80/5/100	79,2			175	324.43
HKUS 100/5/100	99			175	327.88
HKUS 125/5/100	123,8	100 bar	160 bar	175	335.04
HKUS 160/5/100	158,4			175	342.12
HKUS 200/5/100	198			175	349.27
HKUS 250/5/100	247,5			175	359.95
HKUS 320/5/100	316,8			175	370.67
HKUS 400/5/100	396			175	384.00
HKUS 500/5/100	495			175	580.58

RF = RELIEF VALVE SV = SHOCK VALVES HKUS.../5 = FOR FACE MOUNTING PRIORITY VALVE
HKUS.../5T = FOR PIPE MOUNTING PRIORITY VALVE

FURTHER TECHNICAL INFORMATION AVAILABLE ON REQUEST